



**KERALA CO-OPERATIVE MILK MARKETING FEDERATION LTD.
"MILMA BHAVAN", PATTOM PALACE P.O,
THIRUVANANTHAPURAM - 695 004**

BID REF No. 446/PC/CPD/LAB/2018

**BID DOCUMENT FOR SUPPLY OF LAB FURNITURE FOR
SETTING UP OF AUTO CLAVE AND SAMPLE ROOM AT
CENTRAL PRODUCTS DAIRY, PUNNAPRA, ALAPPUZHA
DISTRICT**

2018

BID FORM

1	Registered name of bidder	
2	Address	Office Address
3	Telephone	Land Phone : Mobile : E mail : Fax :

KERALA CO-OPERATIVE MILK MARKETING FEDERATION LIMITED
'Milma Bhavan' PATTOM, THIRUVANANTHAPURAM

INVITATION TO BID

1. The Kerala Co-operative Milk Marketing Federation Limited, invites tenders from bonafide Contractors having sound technical and financial capabilities for **supply of lab furniture for setting up auto clave facility and sample room at Central Products Dairy, Punnapra, Alappuzha**. Interested eligible Bidders may obtain further information from the office of the Kerala Co-operative Milk Marketing Federation Ltd.
2. The bid shall be submitted in two-cover system consisting of technical bid and price bid. The price bid of those who qualify in the technical bid only will be opened.
3. Detailed terms and conditions, scope of work etc as indicated in the invitation to bid are contained in the bidding document of the above work.
 - a. Bid reference : No. 446/PC/CPD/LAB/2018
 - b. Name of work : Supply of lab furniture for setting up of auto clave facility and sample room at Central Products Dairy Alappuzha, Punnapra Alappuzha Dist.
 - c. Estimated value : Rs.4.70 lakhs.
 - d. Tender Publishing : 25.10.2018 at 16.00
 - e. Tender download : Can be downloaded from our website www.milma.com free of cost.
 - f. EMD : Rs.5,000/-.
 - g. Last date and time of submission of bids : 07.11.2018 at 14.00 hrs.
 - h. Bid opening : 07.11.2018 at 15.00 hrs.
 - i. Address for communication and place of bid opening : KCMMF Ltd., Milma Bhavan, Pattom, Trivandrum.
 - j. Bid validity : 90 days from 07.11.2018.
4. All bids must be accompanied by a Bid security (Earnest money) as specified above and must be delivered to the above office on or before the last date and time of receipt of bids as given above.
5. Bids will be opened in the presence of Bidder's representatives who choose to attend the bid opening at the office of KCMMF, Pattom, Thiruvananthapuram 695 004 on the date and time specified above.
6. KCMMF shall not take any responsibility for any sort of delay in receipt of the bidding document if it is sent by post/courier.

Thiruvananthapuram
Date: 25.10.2018.
KCMMF

MANAGING DIRECTOR

GENERAL TERMS & CONDITIONS

1.0 General Information

1.1 Description of works : Supply of lab furniture for setting up of autoclave and sample room at Central Products Dairy, Punnapra, Alappuzha.

1.21 Owner : Managing Director, KCMMF Ltd.

1.3 Location and area

- a. Nearest Railway Station : Alappuzha.
- b. Nearest Airport : Cochin.
- c. Nearest major town : Alappuzha.
- d. Access Roads : Kayamkulam - Alappuzha NH road.

2.0 Period of completion

The period of completion (supply & erection) shall be 90 days from the date of notification of award which shall include the non-working periods during monsoon and festivals. However, the bidders after examining the scope of work and site conditions can specify in the offer the shortest period by which he can complete the above works in all respects.

3.0 Eligibility and qualification requirements.

3.1 For the purpose of this particular contract, bidder should meet the following qualifying criteria as minimum

- a. The bidder should be in business as supplying and setting up of similar type of laboratories in reputed institution/organization for a minimum period of three years at the time of tender opening.
- b. The bidder shall have completed at least three projects of similar nature and value equal to the estimated cost as specified in the tender notice.
- c. The bidder's annual financial turnover during any one of the last three years shall not be less than the value of the estimated cost as specified in the tender notice.
- d. The bidder who possesses valid certified membership of ASHRAE 110-1995 (American Society of Heating, Refrigerating and Air-conditioning Engineers) and SEFA 8 (Scientific Equipment and Furniture Association). The tenders shall indicate the brief details of similar type of lab furniture supplied by them earlier or details of the similar order in hand.

3.2 To be eligible for the award of Contract, bidders shall provide satisfactory evidence to the Kerala Co-operative Milk Marketing Federation regarding their eligibility, capacity and adequacy of resources to carry out the Contract effectively. To this end, all bids submitted shall include the following information which shall be submitted online.

- A. Copies of original document defining the constitution or legal status, place of registration and principal place of business of the company or firm or partnership or if a joint venture, of each party there to constituting the bidder.
- B. Details of the experience and past performance of the bidder (or of each party to a joint venture) on works of similar nature within the last three years, and details of current work in hand and other contractual commitments shall be submitted as per Annexure I Schedule I and Schedule II of this bidding document.
- C. Power of Attorney or a true copy thereof duly attested by a Gazetted Officer in case an authorized representative has signed the bid.
- D. Reports on the financial standing of the bidder such as profit and loss statements, balance sheets and auditor's reports for the past three years.

3.3 Bid submitted by a joint venture of two or more firms as partners shall comply with the following requirements;

- (a) The bid, and in the case of a successful bid the form of agreement, shall be signed so as to be legally binding on all the partners.
- (b) One of the partners shall be nominated as being in-charge; and this authorisation shall be evidenced by submitting a power of attorney signed by legally authorised signatories of all the partners.
- (c) The partner in-charge shall be authorised to incur liabilities and receive instructions for and on behalf of any and all partners of the joint venture and the entire execution of the Contract including payment shall be done exclusively with the partner in charge;
- (d) All the partners of the joint venture shall be liable jointly and severally for the execution of the Contract in accordance with the Contract terms and a relevant statement to this effect shall be included in the authorisation mentioned under (b) above as well as in the form of bid and the form of agreement (in case of the successful bid); and
- (e) A copy of the agreement entered into by the joint venture partners shall be submitted with the bid.
- (f) Experience, resources, men and machinery of each party to the joint venture,

will be taken into only to the extent of their participation for performing tasks under the joint venture agreement.

4. Scope of work.

4.1. Supply & erection of wall tables as per technical specifications.

4.2. Supply & erection of sample storage cabinets as per technical specifications.

5. Plant visit

All the bidders are advised to visit the plant to assess the site condition before the preparing the detailed drawings for the furniture layout for the proposed lab.

6. Price Basis:

The quoted rates should be on FOR site basis inclusive of all taxes, duties, loading charges, packing, forwarding, transit risk insurance, furniture assembling freight by road and all incidental charges for the safe delivery of complete furniture at site. Unloading charges of the items at the site will be borne by Manager, Central Products Dairy, Punnapra, Alappuzha Dist. The materials should be delivered to the Central Products Dairy, Punnapra, Alappuzha Dist. at the following addresses:

Manager,
Central Products Dairy,
Punnapra , Alappuzha Dist.

Prior intimation should be given to Federation/Plant before despatch of materials.

7. Earnest Money Deposit

The offer shall be accompanied by an Earnest Money Deposit of Rs.5,000/- (Rupees five thousand only) in the form of a crossed demand draft drawn in favour of the Managing Director, Kerala Co-operative Milk Marketing Federation Ltd. Payable at Trivandrum.

The Earnest Money Deposit of the unsuccessful bidders shall be returned after the finalization of quotation. No interest will be paid for the period during which the Earnest Money lies in deposit with the Federation.

The Earnest Money of successful bidder will be returned after 6 months from the date of supply in all respects.

The quotations without Earnest Money Deposit are liable to be rejected.

8.0 Delivery and completion period

8.1 The entire furniture indicated in the Annexure II Schedule of Quantities shall be delivered within 90 days from the date of receipt of order. However early period will be appreciated.

- 8.2 In case of failure by supplier, in making deliveries within the time specified, the Federation may procure the materials, supplies and services from other sources and hold the supplier responsible for any losses incurred by the Federation on this account. Further more, the Federation reserves the right to terminate the services of such suppliers, in such cases, without assigning any reason thereof.

9.0 Rejection

9.1 The Federation reserves the right to reject the furniture either in full or in part, if at the time of delivery it is noticed that the items supplied do not conform to the descriptions and the quality stipulated in the specification enclosed herewith.

10.0 Consequence of rejection

If on rejection of the materials by the buyer/or consignee at destination and the supplier fails to make satisfactory supplies within the stipulated period of delivery, the buyer shall be at the liberty to:

- 10.1 Allow the supplier to resubmit the materials in replacement of those rejected within a specified time, the supplier bearing the cost of insurance, if any, on such replacement without being entitled to any extra payment on that account.
- 10.2 Purchase or authorize the purchase of quantity of the materials rejected or others of a similar description (when materials do not exactly comply with the particulars, the opinion of the buyer shall be final) without notice to the supplier, at his risk and cost and without affecting the supplier's liability as regards the supply of any further installment due under the contract.
- 10.3 Cancel the contract and purchase or authorize the purchase of the items or others of a similar description (when materials do not exactly comply with the particular, the opinion of the buyer shall be final) at the risk and cost of the supplier.

11 Removal of rejected items

Any items rejected shall, under all circumstances, lie at the risk of the supplier from the moment of such rejection till their removal and if such materials are not removed by the supplier within such reasonable period as may be decided by the buyer, the buyer may dispose of such materials at the supplier's risk and cost and retain such portion of proceeds as may be necessary to cover any expense incurred in connection with such disposal.

The buyer shall also be entitled to recover handling and storage charges for the period during which the rejected materials are not removed.

12.0 **Guarantee:**

The supplier shall guarantee to repair/replace without any extra cost, the items supplied or part thereof, if found defective due to bad designing, workmanship or substandard material, within 12 months from the date of installation. The entire expenditure towards replacement/repair in this regard shall be borne by the supplier.

13.0 **Terms of payment:**

- a. 85% payment against delivery and inspection of materials.
- b. 10% payment against installation.
- c. 5% payment after completion of guarantee period.

14.0 **Inspection**

KCMMF shall have the right to inspect the goods at the factory of the supplier to ascertain that the goods are manufactured as per the technical specification, prior to dispatch.

15.0 **Agreement**

The successful bidder has to execute an agreement within 15 days of receipt of the order.

16.0 **Liquidated damage clause**

In case the delivery of items is not made within the stipulated period, the supplier shall pay liquidated damage @ 1% (one percent) per week of the order value, subject to a maximum of 10% of the order value.

ANNEXURE - I

SCHEDULE 1

Major lab furniture supply successfully completed during last three years

Sl. No	Item Description	Contract Reference	Name of Client	Value of order	Period of supply

ANNEXURE - I

SCHEDULE I1

WORK IN HAND

Sl. No	Item Description	Contract Reference	Name of Client	Order value	Period of supply

**FORM OF AGREEMENT FOR CIVIL CONSTRUCTION WORK
(On Non-judicial stamp paper of Rs.200/-)**

THIS AGREEMENT made this ----- day of ----- 2016 (Two thousand and sixteen) between Kerala Co-operative Milk Marketing Federation Ltd. A society registered under the Kerala Co-operative Societies Act 1969 (Act 21 of 1969) and having its registered office at Milma Bhavan, Pattom, Trivandrum 695 004 (herein after referred to as KCMMF which expression shall, unless repugnant to the context meaning thereof include the successors and assignees of the KCMMF) of the ONE PART, and -----

----- (hereinafter referred to as the Contractor, which expression shall, unless repugnant to the context or meaning thereof. Include the heirs successors, assignees, executors and administrators of the contractor) of the OTHER PART.

WHEREAS the KCMMF is desirous that certain works should be executed viz., -----
----- by work order no.-----
----- dtd. ----- accepted a bid by the Contractor for the execution. Completion and maintenance of such work.

NOW THIS AGREEMENT WITNESSTH AS FOLLOWS:

1.0 In this agreement words and expressions shall have the same meanings as are respectively assigned to them in the Conditions of Contractor hereinafter referred to

2.0 The following documents shall be deemed to form and be read and constructed as a part of this agreement, viz.,

- i. this Form of Agreement
- ii. the Letter of Acceptance
- iii. the said bid and Appendix
- iv. the Technical Specifications
- v. the Schedule of Quantities
- vi. the Schedule of Supplementary information
- vii. Special Conditions of Contract
- viii. General conditions of contract
- ix. Schedule of Materials to be issued by Owner/KCMMF
- x. Form of Bank Guarantees

3.0 The aforesaid documents shall be taken as complementary and mutually explanatory of one another, but in the case of ambiguities shall take precedence in the order set out above

4.0 In consideration of the payment to be made by the KCMMF to the Contractor as hereafter mentioned, the Contractor hereby covenants with the KCMMF to execute, complete and maintain the works in conformity with the provisions of the contract.

5.0 The KCMMF Ltd. hereby covenants to pay the Contractor in consideration of the execution, completion and maintenance of the works the Contract Price at the times and in the manner prescribed in the Contract.

IN WITNESS WHEREOF the parties hereto have caused their respective common seals to be hereunto affixed the day, month and year first and written.

Signed, sealed and delivered for and on behalf of the within named KCMMF by the hands of its Authorized Signatory.

Authorized Signatory
Kerala Co-operative Milk
Marketing Federation
Limited, Trivandrum.

In the presence of:
Witness:

1. Signature
 Name
 Address

2. Signature
 Name
 Address

Signed, sealed and delivered for an behalf of the within named Contractor the other part. In the presence of:

Witness

1. Signature
 Name
 Address

2. Signature
 Name
 Address

01. Auto clave washing area - WALL TABLE - Item no. 01 as per drawing

Quantity	:	1 No.
Dimension	:	(3200L x 750W x 900H mm)
'C' Frame construction	:	Heavy duty steel frame work will be of rectangular box with a wall thickness of 12 guage, de-grease and powder coated with different dimension of minimum 60x40mm 50x40 mm & 80x40mm.
Material of construction:		
a) Carcass	:	18mm thick BWP plywood laminated with 0.9mm thick laminates, sealed by PVC edge tapes.
b) Shutters	:	The shutters and drawers fronts will have 18mm thick BWP (Boiled Water Proof) Plywood laminated with 0.9mm thick melamine laminates on both sides sealed by 3mm thick PVC edge.
Under bench modular	:	It consists of continuous modular with top drawer and bottom cupboard. Bottom cupboard shall have one no of inner horizontal partition. All the drawer will have locking arrangements.
Top	:	(16 mm) thick trespa will be provided.
Colour	:	Ivory/Blue.

02. WALL TABLE WITH SINK - Item no. 02 as per drawing

Quantity	:	1 No.
Dimension	:	(2500L x 750W x 900H mm)
'C' Frame construction	:	Heavy duty steel frame work will be of rectangular box with a wall thickness of 12 guage, de-grease and powder coated with different dimension of minimum 60x40mm 50x40 mm & 80x40mm
Material of construction:		
a) Carcass	:	18mm thick BWP plywood laminated with 0.9mm thick laminates, sealed by PVC edge tapes.
b) Shutters	:	The shutters and drawers fronts will have 18mm thick BWP (Boiled Water Proof) Plywood laminated with 0.9mm thick melamine laminates on both sides sealed by 3mm thick PVC edge.
Under bench modular	:	It consists of continuous modular with top drawer and bottom cupboard. Bottom cupboard shall have one no of inner horizontal partition. All the drawer will have locking arrangements.
Top	:	(16 mm) thick trespa will be provided.
Sink	:	1 No Polypropylene sink 450x350mm size.
Colour	:	Ivory/Blue.

03. GROUND MOUNTED STORAGE CUPBOARD- Item no. 03 as per drawing

Quantity : 10 Nos.

Dimension : (900L x 400W x 2100H mm)

Material of construction : 18mm thick BWP plywood laminated with 0.9mm thick laminates with 4mm thick glazed doors. The lamination will be done with hot press with minimum of 90 tons pressure all exposed edges will be lipped not less than 0.5mm to protect from moisture and insects. Back will be made of 4mm thick BWP melamine laminated plywood.

The doors will be provided with D-shaped handle and specified good quality locks and key to be provided.

Provide with adjustable and fixed shelves both made of 18+/-mm thick BWP plywood laminated with 0.6mm thick melamine on both sides edges with tape edging.

Where specified vertical partition will be provided at the centre and it will be made of 18+-1mm thick BWP plywood laminated with 0.9mm thick melamine on both sides. The lamination will be done with hot press with minimum of 90 tones pressure. All exposed edges will be lipped not less than 0.5 mm to protect from moisture and insects. The lipping will be machine applied with hot melt glue at a temp of 205 degree Celsius or above.

Nickel coated heavy duty, self closing hinges will be provided which allows an opening up to 165 degree wide and are adjustable in all three directions for perfect finish and correction. Door hinges will be of International make, either Hettich, Hafle, Blum.

Colour : Ivory/Blue.

DRAWINGS

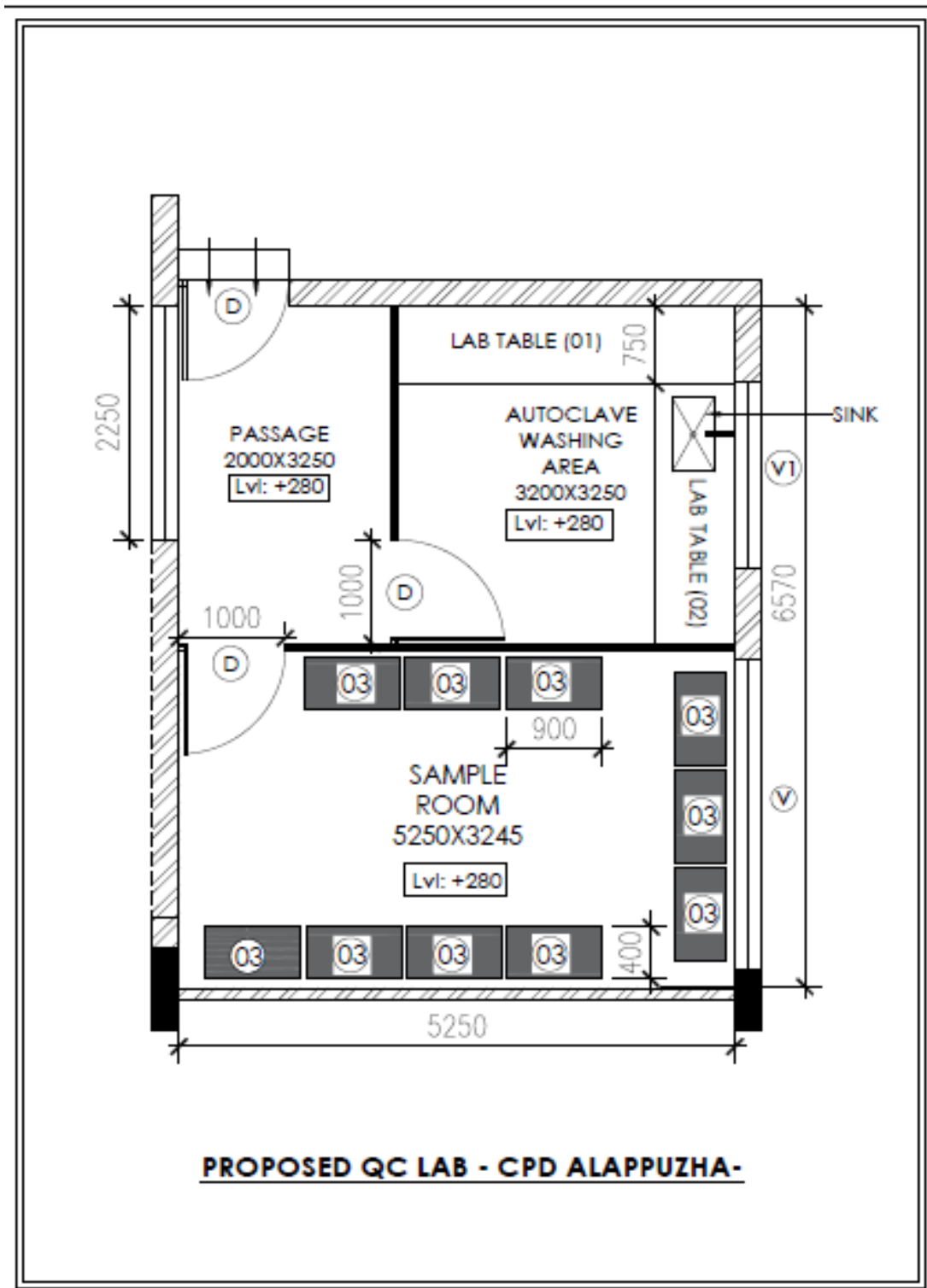

LEGENDS			
Auto Clave and Sample Room			
Sl. No	Description	Dimension	Qty
1	Wall table of trespa work top with back splash	3200L x 750W x 900H mm	1 No.
2	Wall table of trespa work top and back splash with sink	2500L x 750W x 900 H mm	1No.
3.	Ground Mounted sample storage cabinets with glazed doors	900L x 400W x 2100H mm	10Nos.

SCHEDULE OF RATES

Schedule of Quantities

SUPPLY OF LAB FURNITURE FOR SETTING UP AUTO CLAVE FACILITY AND SAMPLE ROOM AT CENTRAL PRODUCTS DAIRY, PUNNAPRA, ALAPPUZHA						
Sl. No	Item Description	Quantity	Units	Basic Rate	GST	Total Amount incl. GST
1	Wall table of trespa work top with back splash	1	No.			
2	Wall table of trespa work top and back splash with sink	1	No.			
3	Ground Mounted sample storage cabinets with glass	10	Nos.			
Total in figures						
Quoted amount in words						